



Introduction and Characteristics 产品介绍及特性

INTRODUCTION

产品介绍

◆ Power inductor takes an important part in the efficiency performance of DC/DC converter. Furthermore, the saturated current performance is also great, so it helps to get the ripple current lower and enhance the efficiency result.

◆ 功率电感器是 DC/DC 转换器转换效率性能的一个重要组成部分。不错的电流饱和性能有助于获得低纹波电流和提高效率。

CHARACTERISTICS

特性

◆ Various high power inductors are superior to be high saturation
◆ Excellent solderability and high heat resistance for reflow soldering or wave soldering
◆ Various high power surface mountable type inductors are superior to high saturation

◆ 大功率，高饱和电流，低阻抗
◆ 良好的焊接性，适合于回流焊或波峰焊
◆ 多种尺寸适合表面高密度贴装

APPLICATIONS

应用产品

◆ DC/DC converters
◆ LCD television
◆ Power supply choke for small electrical equipments such as VTR, LCD display, Notebook, communication equipment, and so on

◆ DC/DC 转换
◆ LCD 电视
◆ 录像机、液晶显示器、笔记本电脑、通讯、设备、办公自动化等电子设备的电源扼流

Wire Wound Power Chip Inductors-HYPI Series

绕线式功率电感-AGPI 系列

PRODUCT IDENTIFICATION 产品型号

AGPI 3511 — 1R2 K

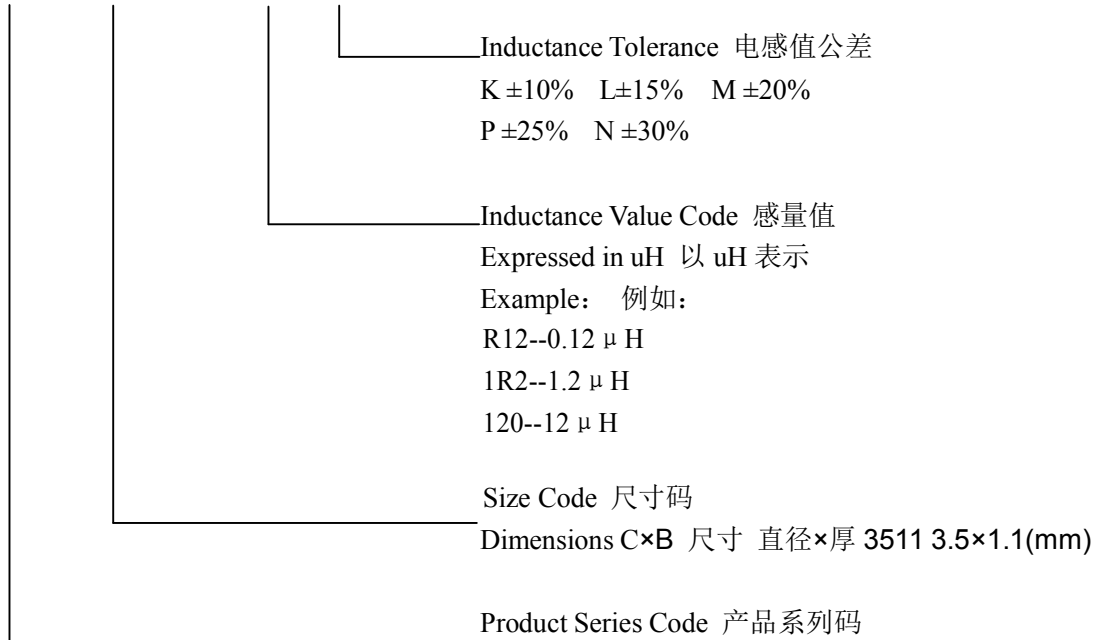

SHAPE AND DIMENSIONS 外观尺寸

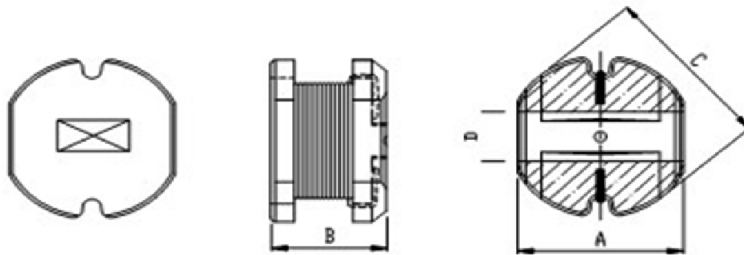

TYPE	A mm	B mm	C mm	D (ref) mm
AGPI3511	3.0 \pm 0.2	1.1 \pm 0.3	3.5 \pm 0.2	0.8
AGPI3216	3.0 \pm 0.2	1.6 \pm 0.3	3.5 \pm 0.2	0.8
AGPI3521	3.0 \pm 0.2	2.1 \pm 0.3	3.5 \pm 0.2	0.8
AGPI4520	4.0 \pm 0.2	2.0 \pm 0.3	4.5 \pm 0.2	1.2
AGPI4532	4.0 \pm 0.2	3.2 \pm 0.3	4.5 \pm 0.2	1.2
AGPI5830	5.2 \pm 0.2	3.0 \pm 0.3	5.8 \pm 0.2	1.5
AGPI5845	5.2 \pm 0.2	4.5 \pm 0.3	5.8 \pm 0.2	1.5
AGPI7835	7.0 \pm 0.2	3.5 \pm 0.3	7.8 \pm 0.2	2.1
AGPI7850	7.0 \pm 0.2	5.0 \pm 0.3	7.8 \pm 0.2	2.1
AGPI1040	9.0 \pm 0.2	4.0 \pm 0.3	10.0 \pm 0.2	2.5
AGPI1054	9.0 \pm 0.2	5.4 \pm 0.3	10.0 \pm 0.2	2.5

AGPI 3511 TYPE

Part Number 型号	Inductance 电感量 L	L Test Condition L 测试频率	DC Resistance 直流电阻 RDC	Rated Current 额定电流 Ir
Units 单位	uH	KHz/V	Ω	mA
AGPI3511-1R0K	1.0	100/0.25	0.08	1400
AGPI3511-1R5K	1.5	100/0.25	0.11	1200
AGPI3511-2R2K	2.2	100/0.25	0.14	1050
AGPI3511-3R3K	3.3	100/0.25	0.20	1000
AGPI3511-4R7K	4.7	100/0.25	0.25	850
AGPI3511-5R6K	5.6	100/0.25	0.32	760
AGPI3511-6R8K	6.8	100/0.25	0.334	720
AGPI3511-8R2K	8.2	100/0.25	0.48	640
AGPI3511-100K	10	100/0.25	0.56	580
AGPI3511-150K	15	100/0.25	0.85	470
AGPI3511-220K	22	100/0.25	0.98	400
AGPI3511-330K	33	100/0.25	1.66	320
AGPI3511-470K	47	100/0.25	2.0	400
AGPI3511-680K	68	100/0.25	3.5	220

AGPI 3516 TYPE

Part Number 型号	Inductance 电感量 L	L Test Condition L 测试频率	DC Resistance 直流电阻 RDC	Rated Current 额定电流 Ir
Units 单位	uH	KHz/V	Ω	mA
AGPI3516-1R0K	1.0	100/0.25	0.055	1800
AGPI3516-1R5K	1.5	100/0.25	0.08	1450
AGPI3516-2R2K	2.2	100/0.25	0.105	1150
AGPI3516-3R3K	3.3	100/0.25	0.15	950
AGPI3516-4R7K	4.7	100/0.25	0.22	750
AGPI3516-5R6K	5.6	100/0.25	0.27	700
AGPI3516-6R8K	6.8	100/0.25	0.30	650
AGPI3516-8R2K	8.2	100/0.25	0.32	600
AGPI3516-100K	10	100/0.25	0.35	550
AGPI3516-150K	15	100/0.25	0.45	450
AGPI3516-180K	18	100/0.25	0.57	400
AGPI3516-220K	22	100/0.25	0.73	350

AGPI3516-330K	33	100/0.25	1.20	300
AGPI3516-470K	47	100/0.25	2.00	250
AGPI3516-680K	68	100/0.25	2.40	200

SPECIFICATIONS 规格特性

AGPI 3521 TYPE

Part Number 型号	Inductance 电感量 L	L Test Condition L 测试频率	DC Resistance 直流电阻 RDC	Rated Current 额定电流 Ir
Units 单位	uH	KHz/V	Ω	mA
AGPI3521-1R0K	1.0	100/0.25	0.04	2250
AGPI3521-1R4K	1.4	100/0.25	0.06	2000
AGPI3521-1R8K	1.8	100/0.25	0.065	1800
AGPI3521-2R2K	2.2	100/0.25	0.08	1700
AGPI3521-2R7K	2.7	100/0.25	0.09	1500
AGPI3521-3R3K	3.3	100/0.25	0.10	1450
AGPI3521-3R9K	3.9	100/0.25	0.13	1200
AGPI3521-4R7K	4.7	100/0.25	0.15	1150
AGPI3521-5R6K	5.6	100/0.25	0.19	1050
AGPI3521-6R8K	6.8	100/0.25	0.24	950
AGPI3521-8R2K	8.2	100/0.25	0.28	900
AGPI3521-100K	10	100/0.25	0.33	800
AGPI3521-120K	12	100/0.25	0.36	700
AGPI3521-150K	15	100/0.25	0.47	650
AGPI3521-180K	18	100/0.25	0.53	600
AGPI3521-220K	22	100/0.25	0.67	550
AGPI3521-270K	27	100/0.25	0.91	500
AGPI3521-330K	33	100/0.25	1.25	450
AGPI3521-390K	39	100/0.25	1.30	400
AGPI3521-470K	47	100/0.25	1.80	350
AGPI3521-560K	56	100/0.25	2.00	320
AGPI3521-680K	68	100/0.25	2.30	300
AGPI3521-820K	82	100/0.25	3.15	280
AGPI3521-101K	100	100/0.25	3.50	260
AGPI3521-270K	270	100/0.25	10.00	160
AGPI3521-331K	330	100/0.25	12.50	140
AGPI3521-471K	470	100/0.25	21.50	120

SPECIFICATIONS 规格特性

AGPI 4520 TYPE

Part Number 型号	Inductance 电感量 L	L Test Condition L 测试频率	DC Resistance 直流电阻 RDC	Rated Current 额定电流 Ir
Units 单位	uH	KHz/V	Ω	mA
AGPI4520-1R0K	1.0	100/0.25	0.035	2700
AGPI4520-1R5K	1.5	100/0.25	0.04	2500
AGPI4520-2R2K	2.2	100/0.25	0.055	2000
AGPI4520-3R3K	3.3	100/0.25	0.07	1750
AGPI4520-4R7K	4.7	100/0.25	0.095	1500
AGPI4520-5R6K	5.6	100/0.25	0.11	1400
AGPI4520-6R8K	6.8	100/0.25	0.14	1200
AGPI4520-8R2K	8.2	100/0.25	0.16	1100
AGPI4520-100K	10	100/0.25	0.20	1000
AGPI4520-150K	15	100/0.25	0.29	820
AGPI4520-180K	18	100/0.25	0.34	800
AGPI4520-220K	22	100/0.25	0.40	680
AGPI4520-330K	33	100/0.25	0.60	550
AGPI4520-470K	47	100/0.25	1.00	460
AGPI4520-680K	68	100/0.25	1.30	390
AGPI4520-820K	82	100/0.25	1.50	350
AGPI4520-101K	100	100/0.25	1.90	320

SPECIFICATIONS 规格特性

AGPI 4532 TYPE

Part Number 型号	Inductance 电感量 L	L Test Condition L 测试频率	DC Resistance 直流电阻 RDC	Rated Current 额定电流 Ir
Units 单位	uH	KHz/V	Ω	mA
AGPI4532-1R0K	1.0	100/0.25	0.033	3800
AGPI4532-1R4K	1.4	100/0.25	0.038	3300
AGPI4532-1R8K	1.8	100/0.25	0.042	2910
AGPI4532-2R2K	2.2	100/0.25	0.047	2600
AGPI4532-2R7K	2.7	100/0.25	0.052	2430
AGPI4532-3R3K	3.3	100/0.25	0.058	2150
AGPI4532-3R9K	3.9	100/0.25	0.076	1980
AGPI4532-4R7K	4.7	100/0.25	0.094	1700
AGPI4532-5R6K	5.6	100/0.25	0.101	1600
AGPI4532-6R8K	6.8	100/0.25	0.120	950
AGPI4532-8R2K	8.2	100/0.25	0.140	1200
AGPI4532-100K	10	100/0.25	0.182	1150
AGPI4532-120K	12	100/0.25	0.210	1050
AGPI4532-150K	15	100/0.25	0.235	850
AGPI4532-180K	18	100/0.25	0.338	840
AGPI4532-220K	22	100/0.25	0.378	760
AGPI4532-270K	27	100/0.25	0.522	710
AGPI4532-330K	33	100/0.25	0.540	640
AGPI4532-390K	39	100/0.25	0.750	590
AGPI4532-470K	47	100/0.25	0.844	540
AGPI4532-680K	68	100/0.25	0.930	370
AGPI4532-101K	100	100/0.25	1.350	400
AGPI4532-221K	220	100/0.25	2.600	370
AGPI4532-331K	330	100/0.25	3.500	220
AGPI4532-471K	470	100/0.25	4.200	180
AGPI4532-561K	560	100/0.25	6.000	120
AGPI4532-681K	680	100/0.25	7.000	100
AGPI4532-102K	1000	100/0.25	12.500	50

SPECIFICATIONS 规格特性

AGPI 5845 TYPE

Part Number 型号	Inductance 电感量 L	L Test Condition L 测试频率	DC Resistance 直流电阻 RDC	Rated Current 额定电流 Ir
Units 单位	uH	KHz/V	Ω	mA
AGPI5845-1R0K	1.0	100/0.25	0.018	5000
AGPI5845-1R8K	1.8	100/0.25	0.025	4000
AGPI5845-2R7K	2.7	100/0.25	0.028	3000
AGPI5845-3R3K	3.3	100/0.25	0.030	2500
AGPI5845-3R9K	3.9	100/0.25	0.032	2000
AGPI5845-4R7K	4.7	100/0.25	0.035	1800
AGPI5845-5R6K	5.6	100/0.25	0.040	1650
AGPI5845-6R8K	6.8	100/0.25	0.045	1600
AGPI5845-8R2K	8.2	100/0.25	0.055	1500
AGPI5845-100K	10	100/0.25	0.10	1440
AGPI5845-120K	12	100/0.25	0.12	1400
AGPI5845-150K	15	100/0.25	0.14	1300
AGPI5845-180K	18	100/0.25	0.15	1230
AGPI5845-220K	22	100/0.25	0.18	1110
AGPI5845-270K	27	100/0.25	0.20	970
AGPI5845-330K	33	100/0.25	0.23	880
AGPI5845-390K	39	100/0.25	0.32	800
AGPI5845-470K	47	100/0.25	0.37	720
AGPI5845-560K	56	100/0.25	0.42	680
AGPI5845-680K	68	100/0.25	0.46	610
AGPI5845-820K	82	100/0.25	0.60	580
AGPI5845-101K	100	100/0.25	0.70	520
AGPI5845-121K	120	100/0.25	0.93	480
AGPI5845-151K	150	100/0.25	1.10	400
AGPI5845-181K	180	100/0.25	1.38	380
AGPI5845-221K	220	100/0.25	1.57	350

SPECIFICATIONS 规格特性

AGPI 7835 TYPE

Part Number 型号	Inductance 电感量 L	L Test Condition L 测试频率	DC Resistance 直流电阻 RDC	Rated Current 额定电流 Ir
Units 单位	uH	KHz/V	Ω	mA
AGPI7835-1R0K	1.0	100/0.25	0.015	6500
AGPI7835-1R8K	1.8	100/0.25	0.020	4500
AGPI7835-2R7K	2.7	100/0.25	0.025	3800
AGPI7835-3R3K	3.3	100/0.25	0.030	3500
AGPI7835-3R9K	3.9	100/0.25	0.032	3000
AGPI7835-4R7K	4.7	100/0.25	0.040	2800
AGPI7835-5R6K	5.6	100/0.25	0.055	2600
AGPI7835-6R8K	6.8	100/0.25	0.065	2400
AGPI7835-8R2K	8.2	100/0.25	0.075	2000
AGPI7835-100K	10	100/0.25	0.080	1900
AGPI7835-120K	12	100/0.25	0.090	1700
AGPI7835-150K	15	100/0.25	0.095	1500
AGPI7835-180K	18	100/0.25	0.100	1400
AGPI7835-220K	22	100/0.25	0.130	1200
AGPI7835-270K	27	100/0.25	0.150	1100
AGPI7835-330K	33	100/0.25	0.180	1000
AGPI7835-390K	39	100/0.25	0.220	900
AGPI7835-470K	47	100/0.25	0.250	850
AGPI7835-560K	56	100/0.25	0.300	800
AGPI7835-680K	68	100/0.25	0.330	700
AGPI7835-820K	82	100/0.25	0.410	650
AGPI7835-101K	100	100/0.25	0.480	600
AGPI7835-121K	120	100/0.25	0.600	550
AGPI7835-151K	150	100/0.25	0.750	500
AGPI7835-181K	180	100/0.25	1.020	450
AGPI7835-221K	220	100/0.25	1.200	400
AGPI7835-271K	270	100/0.25	1.400	320
AGPI7835-331K	330	100/0.25	1.700	280
AGPI7835-471K	470	100/0.25	2.500	250
AGPI7835-561K	560	100/0.25	3.000	240
AGPI7835-681K	680	100/0.25	3.700	220
AGPI7835-821K	820	100/0.25	4.300	200

SPECIFICATIONS 规格特性

AGPI 7850 TYPE

Part Number 型号	Inductance 电感量 L	L Test Condition L 测试频率	DC Resistance 直流电阻 RDC	Rated Current 额定电流 I _r
Units 单位	uH	KHz/V	Ω	mA
AGPI7850-1R0K	1.0	100/0.25	0.030	6800
AGPI7850-1R8K	1.8	100/0.25	0.035	5260
AGPI7850-2R7K	2.7	100/0.25	0.040	4020
AGPI7850-3R3K	3.3	100/0.25	0.045	3600
AGPI7850-3R9K	3.9	100/0.25	0.050	3260
AGPI7850-4R7K	4.7	100/0.25	0.055	2970
AGPI7850-5R6K	5.6	100/0.25	0.060	2740
AGPI7850-6R8K	6.8	100/0.25	0.065	2530
AGPI7850-8R2K	8.2	100/0.25	0.070	2360
AGPI7850-100K	10	100/0.25	0.075	2070
AGPI7850-120K	12	100/0.25	0.080	1850
AGPI7850-150K	15	100/0.25	0.090	1670
AGPI7850-180K	18	100/0.25	0.100	1520
AGPI7850-220K	22	100/0.25	0.110	1400
AGPI7850-270K	27	100/0.25	0.120	1240
AGPI7850-330K	33	100/0.25	0.130	1160
AGPI7850-390K	39	100/0.25	0.160	1050
AGPI7850-470K	47	100/0.25	0.196	960
AGPI7850-560K	56	100/0.25	0.240	870
AGPI7850-680K	68	100/0.25	0.280	790
AGPI7850-820K	82	100/0.25	0.370	720
AGPI7850-101K	100	100/0.25	0.430	650
AGPI7850-121K	120	100/0.25	0.470	590
AGPI7850-151K	150	100/0.25	0.640	530
AGPI7850-181K	180	100/0.25	0.710	490
AGPI7850-221K	220	100/0.25	0.960	440
AGPI7850-271K	270	100/0.25	1.150	400
AGPI7850-331K	330	100/0.25	1.300	360
AGPI7850-391K	390	100/0.25	1.800	330
AGPI7850-471K	470	100/0.25	2.000	300
AGPI7850-561K	560	100/0.25	2.200	280
AGPI7850-681K	680	100/0.25	2.750	250
AGPI7850-821K	820	100/0.25	3.100	230

SPECIFICATIONS 规格特性

AGPI 1040 TYPE

Part Number 型号	Inductance 电感量 L	L Test Condition L 测试频率	DC Resistance 直流电阻 RDC	Rated Current 额定电流 Ir
Units 单位	uH	KHz/V	Ω	mA
AGPI1040-1R0K	1.0	100/0.25	0.015	7200
AGPI1040-1R8K	1.8	100/0.25	0.020	4900
AGPI1040-2R7K	2.7	100/0.25	0.025	4200
AGPI1040-3R3K	3.3	100/0.25	0.030	3500
AGPI1040-3R9K	3.9	100/0.25	0.032	3300
AGPI1040-4R7K	4.7	100/0.25	0.035	3200
AGPI1040-5R6K	5.6	100/0.25	0.040	2800
AGPI1040-6R8K	6.8	100/0.25	0.046	2600
AGPI1040-8R2K	8.2	100/0.25	0.052	2350
AGPI1040-100K	10	100/0.25	0.071	2150
AGPI1040-120K	12	100/0.25	0.076	2000
AGPI1040-150K	15	100/0.25	0.090	1700
AGPI1040-180K	18	100/0.25	0.089	1650
AGPI1040-220K	22	100/0.25	0.100	1450
AGPI1040-270K	27	100/0.25	0.120	1350
AGPI1040-330K	33	100/0.25	0.130	1200
AGPI1040-390K	39	100/0.25	0.160	1100
AGPI1040-470K	47	100/0.25	0.190	1000
AGPI1040-560K	56	100/0.25	0.220	900
AGPI1040-680K	68	100/0.25	0.250	800
AGPI1040-820K	82	100/0.25	0.300	750
AGPI1040-101K	100	100/0.25	0.380	650
AGPI1040-121K	120	100/0.25	0.440	600
AGPI1040-151K	150	100/0.25	0.520	550
AGPI1040-181K	180	100/0.25	0.600	500
AGPI1040-221K	220	100/0.25	0.750	450
AGPI1040-271K	270	100/0.25	0.880	400
AGPI1040-331K	330	100/0.25	1.150	380
AGPI1040-391K	390	100/0.25	1.380	340
AGPI1040-471K	470	100/0.25	1.640	320

AGPI1040-561K	560	100/0.25	2.060	290
AGPI1040-681K	680	100/0.25	2.550	260
AGPI1040-821K	820	100/0.25	3.100	240
AGPI1040-102K	1000	100/0.25	3.550	220

SPECIFICATIONS 规格特性

AGPI 1054 TYPE

Part Number 型号	Inductance 电感量 L	L Test Condition L 测试频率	DC Resistance 直流电阻 RDC	Rated Current 额定电流 Ir
Units 单位	uH	KHz/V	Ω	mA
AGPI1054-1R0K	1.0	100/0.25	0.010	7600
AGPI1054-1R8K	1.8	100/0.25	0.012	6220
AGPI1054-2R7K	2.7	100/0.25	0.020	4560
AGPI1054-3R3K	3.3	100/0.25	0.025	4560
AGPI1054-3R9K	3.9	100/0.25	0.028	4020
AGPI1054-4R7K	4.7	100/0.25	0.031	3600
AGPI1054-5R6K	5.6	100/0.25	0.035	3260
AGPI1054-6R8K	6.8	100/0.25	0.039	2970
AGPI1054-8R2K	8.2	100/0.25	0.042	2740
AGPI1054-100K	10	100/0.25	0.045	2530
AGPI1054-120K	12	100/0.25	0.065	2210
AGPI1054-150K	15	100/0.25	0.069	2070
AGPI1054-180K	18	100/0.25	0.080	1850
AGPI1054-220K	22	100/0.25	0.090	1670
AGPI1054-270K	27	100/0.25	0.098	1520
AGPI1054-330K	33	100/0.25	0.114	1340
AGPI1054-390K	39	100/0.25	0.123	1240
AGPI1054-470K	47	100/0.25	0.150	1160
AGPI1054-560K	56	100/0.25	0.160	1050
AGPI1054-680K	68	100/0.25	0.220	940
AGPI1054-820K	82	100/0.25	0.270	870
AGPI1054-101K	100	100/0.25	0.320	790
AGPI1054-121K	120	100/0.25	0.400	690
AGPI1054-151K	150	100/0.25	0.470	620
AGPI1054-221K	220	100/0.25	0.680	510
AGPI1054-271K	270	100/0.25	0.840	460
AGPI1054-331K	330	100/0.25	1.010	420

AGPI1054-391K	390	100/0.25	1.180	390
AGPI1054-471K	470	100/0.25	1.420	350
AGPI1054-561K	560	100/0.25	1.720	320
AGPI1054-681K	680	100/0.25	2.100	290
AGPI1054-821K	820	100/0.25	2.580	260
AGPI1054-102K	1000	100/0.25	3.430	240